

Gulf of Mexico- WesternGeco Ship Shoal, Offshore Louisiana

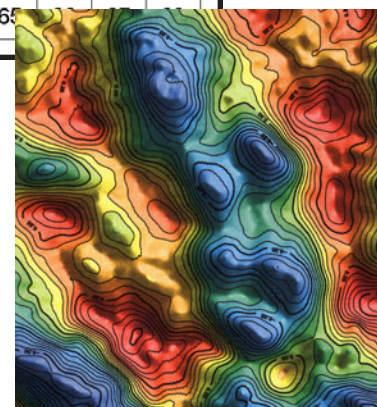

High-Resolution Marine Gravity and Bathymetry Data

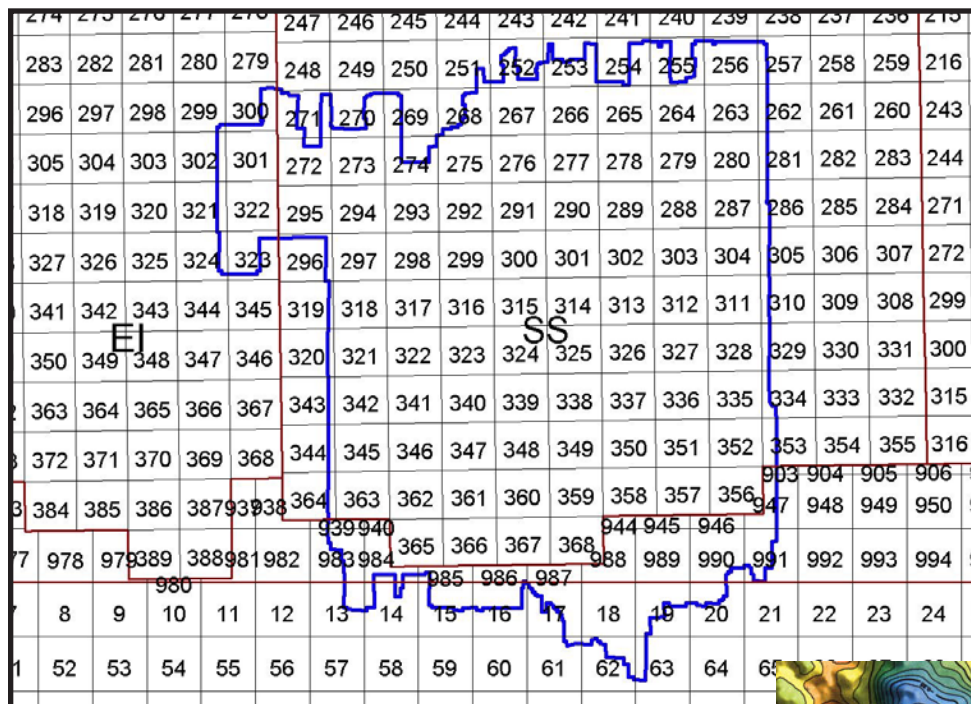

Typical Bouguer Residual Anomaly from a GOM 3D Gravity Survey (contour interval 0.05mGal, horizontal dimension is 15 miles)

Gravity Coverage

Approximately 80 OCS Blocks

Bathymetry

High resolution bathymetry for the area, recorded on the 3D survey. (As processed by FUGRO-LCT)

Sampling

Ship tracks 240 meters (approx.) one second along line sampling (3 meters along ship tracks)

Final grids

200 meter grid interval of free air and 3D Bouguer gravity and bathymetry with a color shaded residual gravity map.

Applications

- Salt flank/dip modeling and determination
- Base salt modeling
- Salt/sediment determination
- Seismic velocity modeling/verification

Digital Data

All digital data and grids will be provided on 8mm tape or CD.

Availability

Available for IMMEDIATE delivery. Data and interpretation costs available upon request.

FUGRO-LCT INC.
6100 Hillcroft
Houston, Texas 77081, U.S.A.
Tel: 713-369-6100
Fax: 713-369-6110
E-mail: info@lct.com



Web site: www.lct.com